

United States Department of the Interior
National Park Service

**National Register of Historic Places
Inventory—Nomination Form**

4

For NPS use only	
received	
date entered	

Continuation sheet

Item number

Page

Name: Historic: Robbs House Location: 310 W. Buford St.
Common: Robbs House Classification: Building

Owner: M.R. Robbs est.
c/o Marjorie Steadman, et al.
406 Union Street
Gaffney, S.C. 29340

Representation in Existing Surveys: South Carolina Inventory of Historic Places, 1985

Description: The Robbs House has a central passage I-house plan with a two-story brick ell at the rear. The roof is a jerkinhead gable form with a central jerkinhead gable on the main (south) facade. A prominent feature is the two-story porch with milled posts, fan brackets, a spindled railing and decorative frieze composed of spindles and sawtooth vergeboard. The house has five-course common bond brickwork with pilasters framing the main entrance, which features its original door with border glass. Windows are two-over-two rounded arch sash. Outbuildings on the lot include an original brick stable which has a large rounded arch doorway with three-course brick relief arching. To the west of the house is a ca. 1900 brick carriage house with six-light fixed windows and a shed roof. The house and outbuildings are presently vacant.

Significance: The Robbs House, built by Thompson Robbs in 1884, is one of the oldest homes standing in Gaffney and was one of the few brick homes constructed in the town in the nineteenth century. The house is architecturally significant due to its craftsmanship and essentially unaltered condition. It retains its original finely detailed porch and a collection of early outbuildings. Thompson Robbs was a wealthy merchant and farmer who settled in Gaffney soon after it was founded. (66) The Robbs family continued to be prominent in the community into the early 20th century; the home is still owned by descendants of the family. (67)

Acreage: Approximately 1.3 acres

Verbal Boundary Description: The boundary for the Robbs House is shown as the dark line on accompanying Cherokee County Tax Map 81-15, which is drawn at a scale of 1"=100'. The boundary includes the house, outbuildings and property historically associated with the Robbs House.

UTM Reference Point: 17/440520/3881260

Other information:

Level of Significance: Local

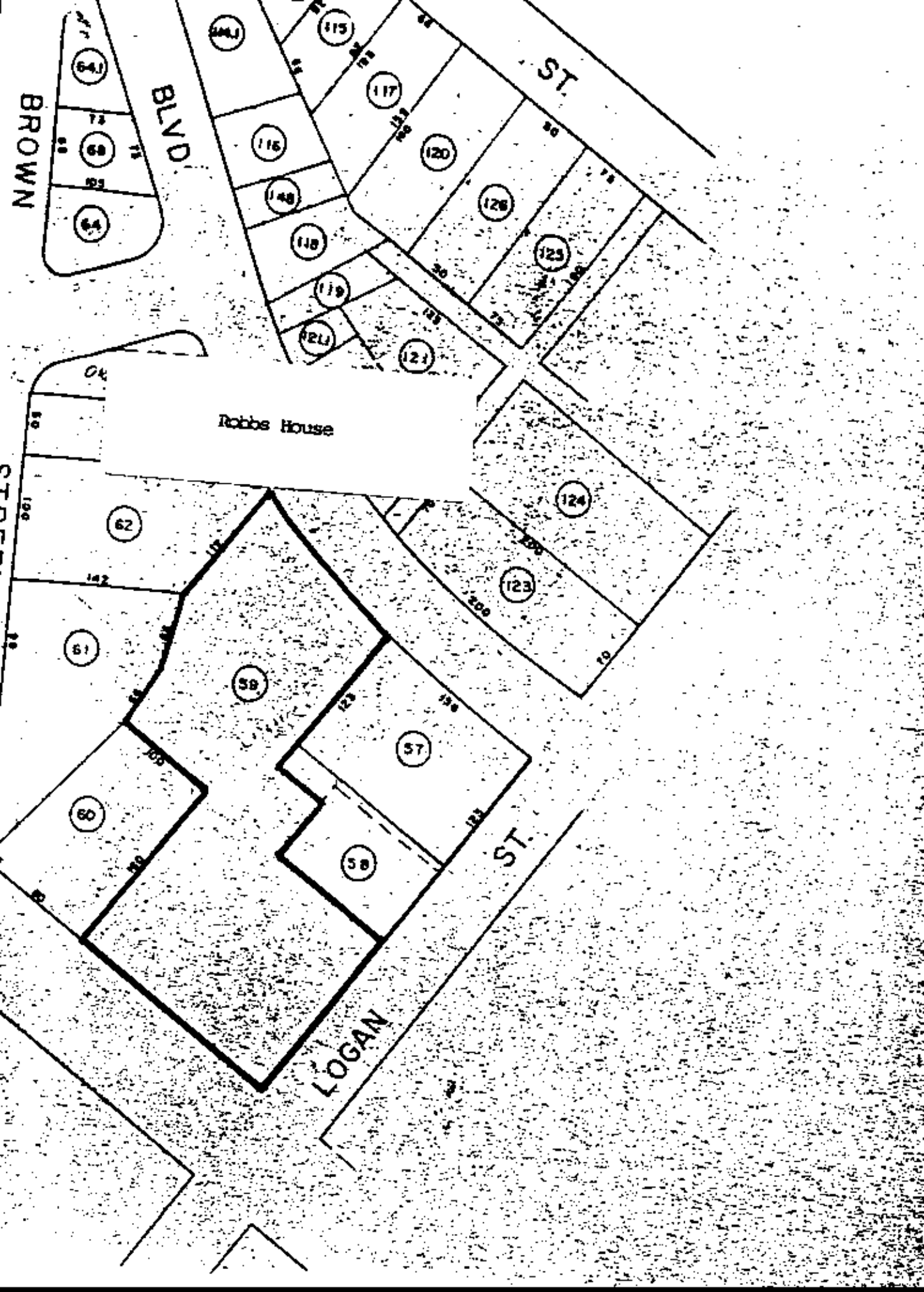

BROWN

BLD

ST.

Robbs House

LOGAN

ST.

54

55

56

57

62

61

60

59

57

58

148

115

117

116

148

118

119

121

121

120

126

125

124

123

ST.