

UNITED STATES DEPARTMENT OF THE INTERIOR
Heritage Conservation and Recreation Service

NATIONAL REGISTER OF HISTORIC PLACES INVENTORY
NOMINATION FORM

Continuation Sheet

Item Number

Page

Name Historic; Pinopolis Historic
District North
Common

Location: Along the east side of the Pinopolis
peninsula, on the shore of Lake Moultrie

Classification: District

Owner: See continuation sheet

Representation in Existing Surveys: Inventory of Historic Places in South Carolina, 1981

Description: Pinopolis Historic District North, which consists of seven properties, includes four of the nineteenth century retreats that helped to engender Pinopolis. The houses are uniformly of frame construction and abstain from the stylistic pretensions of the permanent planters' seats of the period in accord with their status as houses of retreat. The buildings in the district date from ca. 1834 to ca. 1883 and retain in large measure their original forms and features. The district is heavily wooded with pine trees and heavy undergrowth. No paved roads and no contemporary construction have yet assailed this part of Pinopolis.

Significance: Pinopolis Historic District North includes four of the early planters' retreats that characterized this pineland village. The district is unified by the absence of contemporary buildings, the heavy foliage, the absence of paved roads, and the cohesiveness of the four residences, which are uniformly of frame construction, weatherboarded, with large porches and few stylistic aspirations. The buildings are representative of nineteenth century vernacular forms and construction technology.

Acreage: approximately 16

Verbal Boundary Description: The boundary of the Pinopolis Historic District North is shown as the red line on the accompanying Berkeley County Tax Map # 102-02-03, 102-02-04, sheet 1 of 2, drawn at a scale of 1 inch = 200 feet. This boundary includes the greatest number of historic buildings in this part of Pinopolis and the fewest nonhistoric intrusions.

UTM Reference Point

A. 17/590107/3677410
C. 17/589822/3676810

B. 17/589930/3676815
D. 17/589947/3677420

Other Information

**United States Department of the Interior
Heritage Conservation and Recreation Service**

**National Register of Historic Places
Inventory—Nomination Form**



Continuation sheet

Item number

Page

Tax Map#

102-02-04-50

Property Owner

Eugene F. Oliver
General Delivery
Pinopolis, S.C. 29469

102-02-04-37

William J. & Nell M. Iselin
Box 506
Moncks Corner, S.C. 29461

102-02-04-33

Miss Florence Lucas
General Delivery
Pinopolis, S.C. 29469

102-02-04-40

Francis Marion Kirk
ODC Paraquay
APO Miami, Fla. 34036

102-02-04-39

102-01-00-022

Martin, Bettina P.
Pinopolis, S.C. 29469

102-02-04-34

122-01-00-031

Cain, Elizabeth Heirs of
c/o C. L. Cain
Pinopolis, S. C. 29469

102-02-04-42

122-01-00-029

Cain, Elizabeth Heirs of
c/o C. L. Cain
Pinopolis, S. C. 29469

United States Department of the Interior
Heritage Conservation and Recreation Service

**National Register of Historic Places
Inventory—Nomination Form**

For HCRS use only

received

date entered

Continuation sheet

Item number

Page

Properties defining the historic character of the district:

1. Isaac Porcher House, ca. 1844. A frame one-and-one-half-story, weatherboarded residence with a steep gabled roof and a wraparound, shed roofed porch. The porch, which has been screened in, has simple square posts and a plain balustrade. The building is set on high brick piers. A brick chimney with a plastered necking band pierces the standing seam metal roof; another brick chimney appears to be a later addition. The windows are six-over-six, double-hung sash. The property includes a small frame outbuilding which was once used as an office.

3. Charles Macbeth House, pre-1883. A one-and-one-half-story, weatherboarded, frame residence with a steep gabled, metal roof and a shed roofed porch across its facade. The building has one internal chimney which has a corbeled cap and a plaster necking band. The house has a brick pier foundation. The window sash is six-over-six. The porch, one-half of which has been screened, has simple wooden piers. A small frame wing has been added to the rear of the house.

5. William Cain House, ca. 1834. A two-story, weatherboarded, frame house with a steep, metal clad gable roof and a low brick pier foundation, built by the planter William Cain. The house has a central-hall plan with a five-bay facade and a one-story porch that wraps around two sides of the house. Two brick exterior chimneys rise above the roofline. The roof has a boxed cornice with returns. The original cypress shingles are intact beneath the metal roofing. The window sash is nine-over-nine with shutters. The house is also known as Somerset House, after the name of the main Cain plantation. The property also includes the William Cain House lodge, a small one-story, weatherboarded lodge with a gabled metal roof and a small entrance porch. The lodge has two rooms and nine-over-nine windows.

7. Lucas House, ca. 1835. A two-story, weatherboarded, frame residence with a gabled roof covered in corrugated metal. A single internal chimney with a corbeled cap rises above the roof; there are also two external chimneys with corbeled caps. The facade is five bays wide with a full length hip roof porch. The window sash is nine-over-nine. There are numerous small frame additions on the rear of the house. The property, which is heavily wooded, includes some original frame outbuildings.

Other properties contributing to the character of the district:

2. Undeveloped, wooded lakefront property.
4. Undeveloped, heavily wooded property.
6. Undeveloped, heavily wooded property.



S-8-5

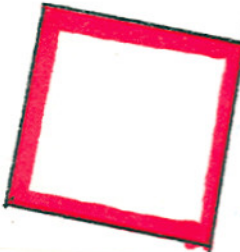

William Robertson House

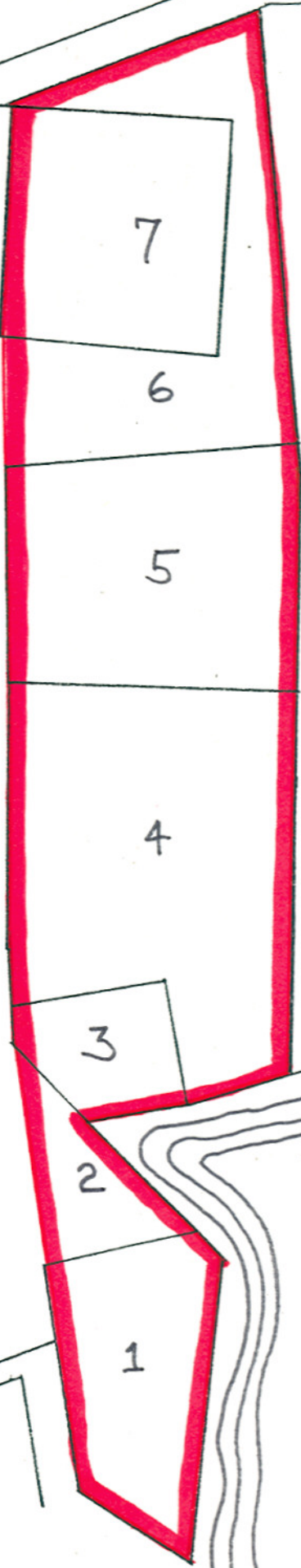

7

6

5

4

3

2

1

Pinopolis Historic District North

Berkeley County, South Carolina

TM 102-02-03
102-03-04

Scale 1" = 200'

Lake Moultrie

